



WI-LTE113-O

4G LTE Outdoor CPE
Quick Install Guide

www.wireless-tek.com

Package content



Feedhrn



Dish



Feed Receiver



Ball Joint Mount



Metal Strap



24V POE Adapter



Quick setup guide

Hardware Overview



LED	Description	No.	Description
PWR	On: the radio is powered up	1	Ethernet port
LTE	On:connected to the internet Off:not connected to the internet	2	Reset button Press more than 8s to restore factory settings
ETH	On: the wire connection is available Flashing: wire data transferring	3	SIM Slot : Micro SIM Card

Mounting



Combine the two parts of the dish reflector.

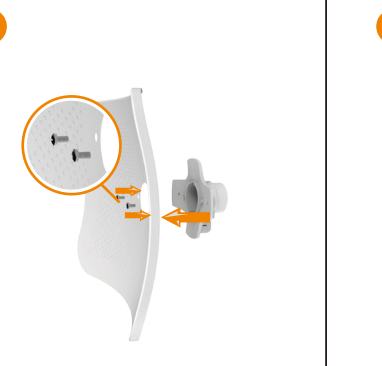

Hold the reflector assembly by hand (do not use tabletop or flat surface) and insert the **Feed Receiver** into the reflector, secure it with two screw.



Insert the Micro **SIM** card and close the silicone cover. And then insert the **Radio Feed** into the Feed Receiver.



Attach the **Ball Joint Mount** to the Feed Receiver by turning the lock nut clockwise by hand. Do not tighten the nut.

Mounting



Pull out the port cover and connect an Ethernet cable to the port, then push back the cover.



Open the **Metal Strap** and feed it through the two slots of the Ball Joint Mount, then wrap the Metal Strap around the pole.



Loosen the lock nut on the Ball Joint Mount, and aim at the other end of the wireless link. After that lock the nut.

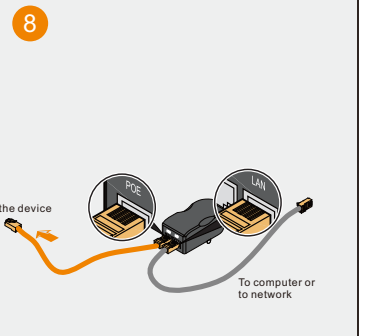

Power up the device, **plug and play**.

Web configuration

Launch your web browser then enter **http://192.168.1.1** in the address bar and specify the default login key: **admin**.

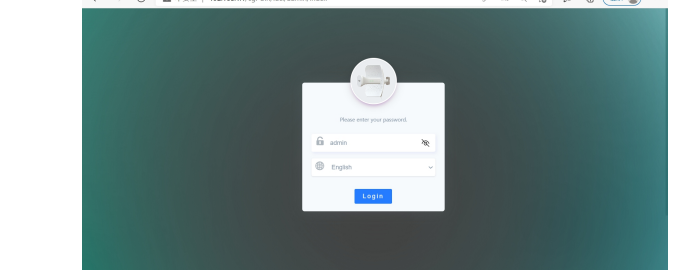

Configuration complete.

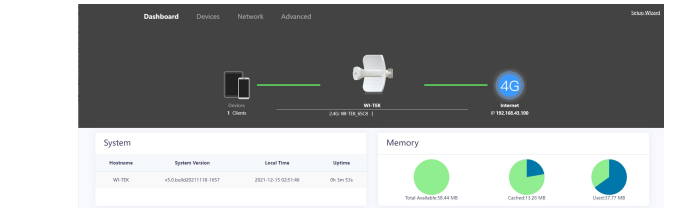

Cloud Management Setting(Optional)

Cloud management settings

Step 1 Launch your web browser then enter **http://cloud2.wireless-tek.com** in the address bar.

Step 2 Register an account password by user name or email.

Step 3 log in to the cloud account with the account password after registration.

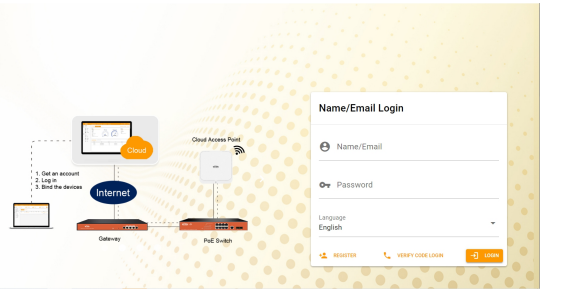

After the login is successful, the steps to bind the device on the cloud account are as follows:

1) Click **ADD NETWORK**

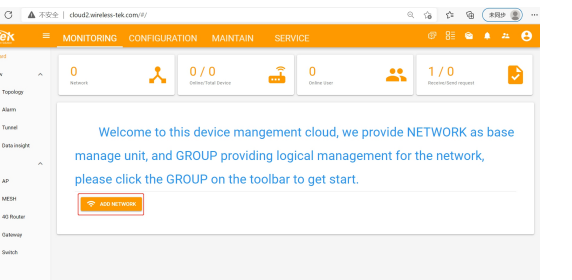

Cloud Management Setting(Optional)

2) Fill in the group name and location, click save.

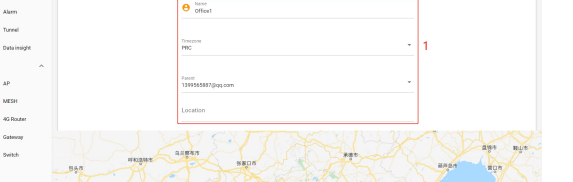

3) And click next.

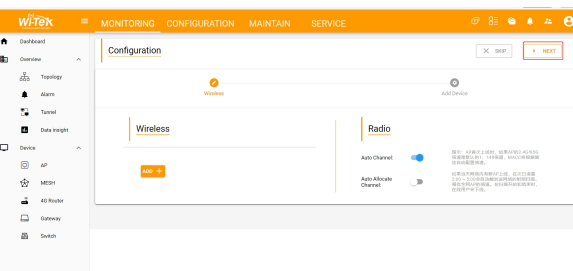

4) Enter serial number, click **ADD** to create and click **FINISH**, the configuration is complete.

Note:
The 17-digit SN code of the 4G Router is shown on the sticker on the back of the device.

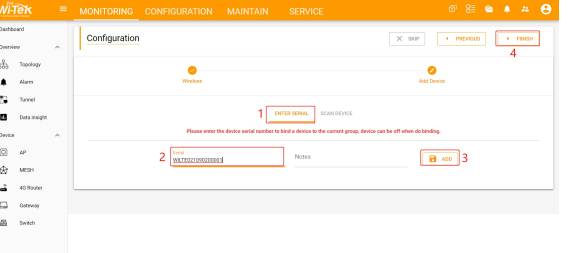

Cloud Management Setting(Optional)

5) In the relevant device options, you can see the bound device information.

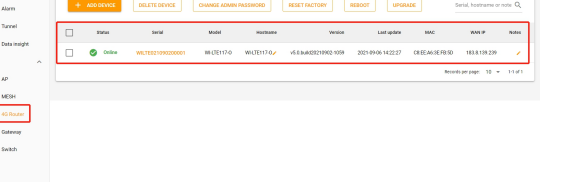

6) Click **Tunnel**, select **4G Router**, click **EWEB** to log in to the device.

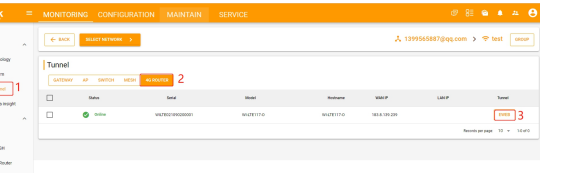

Warranty Card

Username	
Address	
Telephone No.	
Purchase Shop	
Purchase Address	
Product Model No.	
Purchase Time	
Serial No.	
Dealer Signature	

- If the product defects within three months after purchase, we will provide you a new product of the same model.
- If the product defects within the three-year warranty period, we will provide the professional maintenance service.
- Proof of purchase and a complete product serial number are required to receive any services guaranteed as part of the limited warranty.
- Any other defects that are not caused by workmanship or product quality, such as natural disaster, water damage, extreme thermal or environmental conditions, sticker damaged, warranty card losing will disqualify the product from limited warranty.



Technical Support



Cloud Management



Company Website

Wireless-Tek Technology Limited
Address: Room 402 4F, BiaoFan Technology Building, Bao'An Avenue, FuYong Town, Bao'An district, ShenZhen
Website: www.wireless-tek.com
Tel: 86-0755-32811290
Email: sales@wireless-tek.com
Technical Support: tech@wireless-tek.com

